

Surrey Hills Arts

Inspiring Views – Artist Brief

Discovering, revealing and interpreting views of the Surrey Hills

Background

Surrey Hills Arts (a partnership between Surrey Arts, SCC and Surrey Hills AONB) are commissioning an artwork incorporating seating on the Albury Estate in Surrey. The artwork will highlight the inspiring view at a point on the North Downs Way, a short walk from Newlands Corner. It will provide a reason to visit, pause and appreciate each specific location while encouraging interaction from visitors.

Aims

Through the *Inspiring Views* project, Surrey Hills Arts anticipate:

- opening up a new viewpoint
- attracting new visitors to walk the North Downs Way to the artwork
- improving access to the site for all, including visitors with disabilities
- allowing regular visitors to experience the landscape in a new way
- promote the Surrey Hills as a place for reflection and inspiration
- engage local residents through associated activities

The Brief

The selected artwork will include seating, demonstrate high quality, consider the local environment in the materials used, and celebrate the unique identity of the site. Surrey Hills Arts are open to ideas and suggestions regarding the nature of the work such as a viewing platform, bench that frames a view, more than one structure, a sound bench or the possibility of incorporating different art forms and are particularly interested in an interactive element.

The artworks should be:

- Relevant to the cultural and environmental context of the area
- Thought provoking and educational
- Constructed in natural, locally sourced materials where possible
- Durable and requiring minimal maintenance
- Safe and not constitute a hazard to public or the environment
- Environmentally sustainable

The Role of the Artist/Craftsperson

The artist will be responsible for the concept, design, fabrication and installation of the artwork in consultation with Surrey Hills Arts, and the landowner. The artist will work within a budget of £9000 initially being involved in our crowd funding campaign. Linked talks and community workshops will have an additional fee. The artist will initially be paid £250 to work up a proposal with visual and/or maquette.

The Surrey Hills Arts Programme Manager will oversee the project delivery and support the appointed artist. The artist will provide drawings and specifications and plan the installation with the land owner.

The artist will take part in the press and marketing opportunities relating to the commission and assist in documenting the process. It is essential that the artist participates in talks, and/or community workshops as part of the project delivery. The artist will undergo a DBS check where required. The artist will be expected to provide regular updates on the progress of the project to Surrey Hills Arts and attend meetings as required. The artist will be required to provide a maintenance plan to the commissioner to preserve the life of the finished artwork/seating.

Please note that any costs for travel and accommodation incurred by the artist are included in the overall commissioning fee.

The project will be documented through photography and film throughout the process.

Community Participation

This can take the form of walks, talks, workshops or demonstrations. It can involve local groups of all ages and abilities including local artists. The community participation programme will be developed with the Programme Manager and artist, and respond to local need.

The Location

Nearest parking is at Drove Rd, Albury, Guildford GU4 8SE. From here, cross the A25 and enter the woodland on the North Downs Way. The location is a short walk on your right where an old bench is partially hidden.

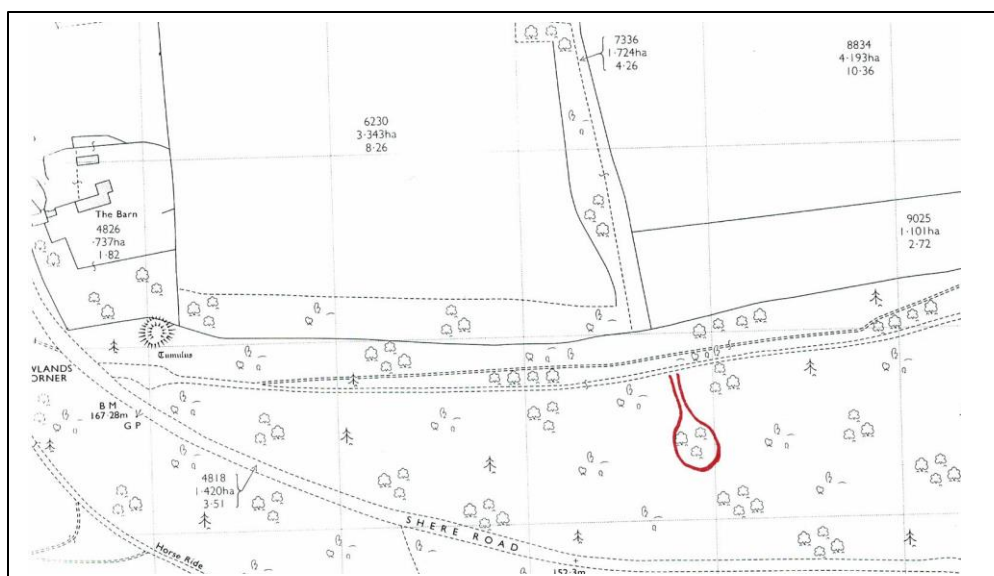

Deadline for submissions: **22 April 2019**

This project is not yet fully funded and we intend to generate sufficient interest in this project in order to generate the remaining balance through a crowdfunding campaign, for which we will require the selected artist's support

- The Surrey Hills Arts Programme Manager will oversee the project delivery and will be the main point of contact for the appointed artist.
- Once the additional funding is secured, we anticipate an Autumn 2019 or Spring 2020 start.

Application and Selection

Application is open to artists from London and the South East including Hampshire and Berkshire.

To apply, artists/craftspeople must send the following on one pdf document:

1. Current CV with two references and website link
2. Up to six images of relevant work
3. Expression of interest including initial ideas or ways of working

A panel consisting of the Surrey Hills Arts Programme Manager, Landowner, Curator, Public Art Advisor and Craft Specialist will select the artist. The panel are looking for a high level of craftsmanship, originality of ideas, sympathy with the environment and a willingness to engage with local people.

The deadline for application is: 22 April 2019.

Submissions can be emailed to surreyhillsarts@gmail.com or sent to:
Ali Clarke, Programme Manager, Surrey Hills Arts, Warren Barns, Headley Lane,
Mickleham, RH5 6DG.

For further information, email surreyhillsarts@gmail.com or call 07968 834657.

www.inspiringviews.org

This will be the sixth 'Inspiring Views' commission in the Surrey Hills, see:

